

# \$475,000 - Sas RI H (sw Part), Rural Sturgeon County

MLS® #E4413923

**\$475,000**

0 Bedroom, 0.00 Bathroom,  
Rural on 6.16 Acres

None, Rural Sturgeon County, AB

Amazing location for brand new home. Direct access on paved highway to St. Albert 10 min. & west Edmonton 10 min. thru Yellowhead Hwy. There are a few acres naturally set up for a walk out basement style home. Your view could be a creek and natural wetlands out your back door. Golf a lot; Deer Meadows Golf Course is approx. 1 km away. The property receives revenue from Altalink Management for powerline passing by the property, \$438/yr. Atim Creek, which is nearby, is frequently tested as a part of the Provincial Park, the results show potable water. This property is alongside the tip of the Lois Hole Centennial Provincial Park. In picture #2 there is an orange triangle showing this sliver of the park separating this property from the one to the south. No immediate neighbors. Natural gas line passes through the north side.

## Essential Information

|           |                 |
|-----------|-----------------|
| MLS® #    | E4413923        |
| Price     | \$475,000       |
| Bathrooms | 0.00            |
| Acres     | 6.16            |
| Type      | Rural           |
| Sub-Type  | Vacant Lot/Land |
| Status    | Active          |

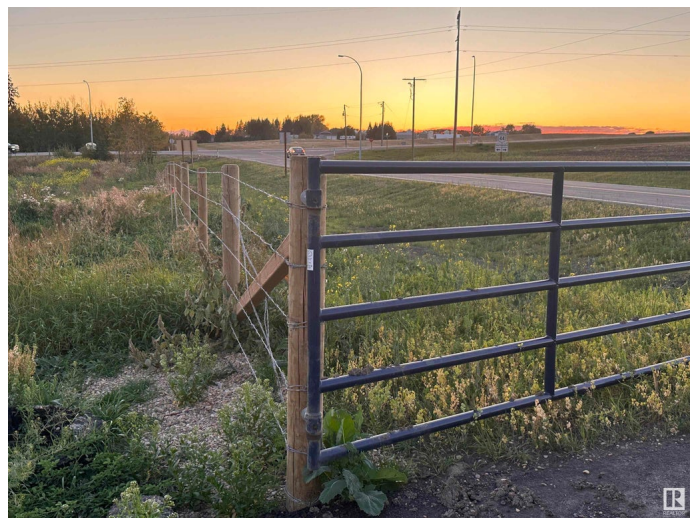

## Community Information

|             |                       |
|-------------|-----------------------|
| Address     | Sas RI H (sw Part)    |
| Area        | Rural Sturgeon County |
| Subdivision | None                  |
| City        | Rural Sturgeon County |
| County      | ALBERTA               |
| Province    | AB                    |
| Postal Code | T8T 0L6               |

## Exterior

Exterior Features Airport Nearby, Backs Onto Park/Trees, Corner Lot, Environmental Reserve, Flat Site, Golf Nearby, Shopping Nearby, Stream/Pond, Street Lighting

## Additional Information

|                |                     |
|----------------|---------------------|
| Date Listed    | November 18th, 2024 |
| Days on Market | 139                 |
| Zoning         | Zone 70             |

DATA IS DEEMED RELIABLE BUT IS NOT GUARANTEED ACCURATE BY THE REALTORS® ASSOCIATION OF EDMONTON. COPYRIGHT 2025 BY THE REALTORS® ASSOCIATION OF EDMONTON. ALL RIGHTS RESERVED. Trademarks are owned or controlled by the Canadian Real Estate Association (CREA) and identify real estate professionals who are members of CREA (REALTOR®, REALTORS®) and/or the quality of services they provide (MLS®, Multiple Listing Service®)

Listing information last updated on April 6th, 2025 at 5:32am MDT